

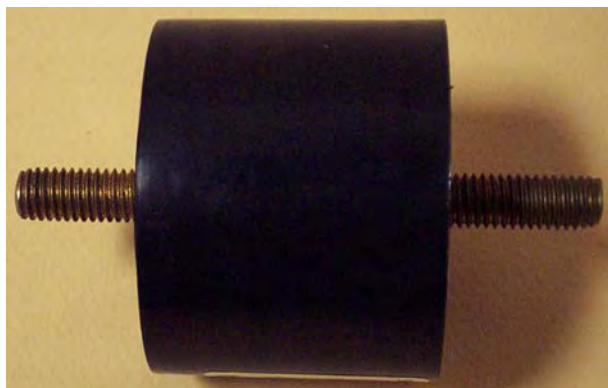

DATA SHEET
MODEL LPC 11550 SERIES
DC POWER LIGHTNING AND SURGE ARRESTERS



Model LPC 11550-series

Two terminal surge arrester, 5/16"-18 X 3/4" long threaded studs. Enclosure is insulating 2" dia. X 1 1/2" high. Two or more may be placed in parallel for higher surge current capability. May be connected plus to minus, or plus to ground, or minus to ground.

OPERATION

Model LPC 11550 series DC power arresters are designed to protect equipment against electrical transients caused by lightning, induction, switching surges, EMP, and any other overvoltages of short duration. Response is less than a nanosecond. The arrester remains in the conducting state until the surge passes. It restores itself instantly, and is automatically ready for the next operation. There is no power follow current, no voltage dip, and no power interruption.

INSTALLATION

The arresters are maintenance free and have long life. The enclosure is insulating, made of high impact plastic material, resistant to ultra violet radiation. Brass threaded studs are provided as terminations. Connections are made between the "hot" cable, rail, etc. and ground using #8 AWG or larger cable. Connections may also be made between the (+) and (-) bus. The arrester is bipolar, allowing either terminal to be used for plus and minus connections. One end of the arrester may be bolted to a ground plate with the other end cabled to the "hot" connection.

Multiple units may be used in parallel for additional surge capacity. Each unit may be fused to remove it from the circuit in the event of failure. Failure occurs due to overheating when the surge energy exceeds the rating of the arrester. Initially failure is in the form of a short circuit condition followed by an open circuit due to rupture of arrester components and/or open fuses.



LIGHTNING PROTECTION CORPORATION

Mailing Address :	P.O. Box 6086	Telephone :	(805) 967 4577
	Santa Barbara, CA 93160		(800) 317 4043
Plant Address :	5750 Thornwood Dr.	Fax :	(805) 967 4320
	Goleta, CA 93117		
Website :	lightningprotectioncor.com		
Email :	info@lightningprotectioncor.com		

**SPECIFICATIONS
MODEL LPC 11550 SERIES
DC POWER LIGHTNING AND SURGE ARRESTERS**

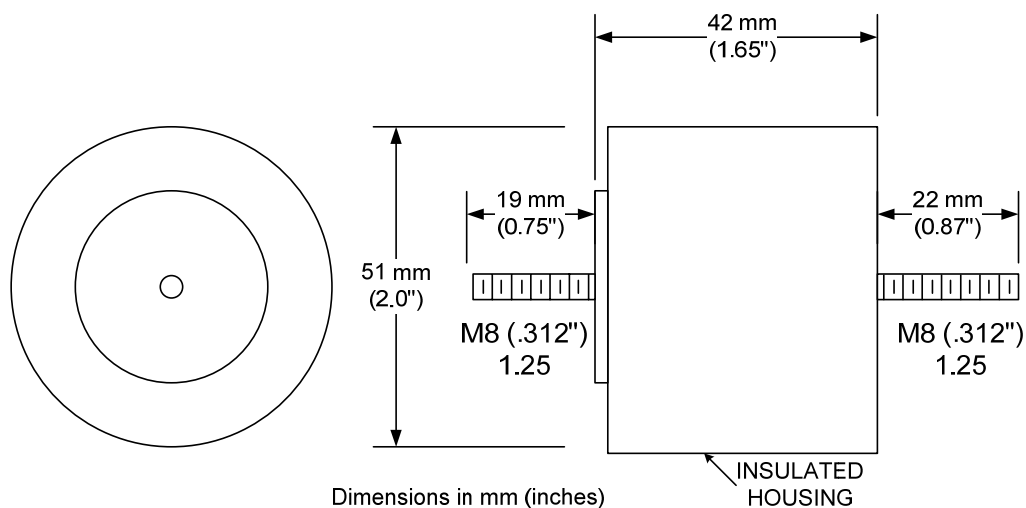

Standard Models

Model No.	Max. DC Voltage Rating	Surge Current Rating 8/20 μ s wave
LPC 11550 - 212	18	25 KA
- 224	36	25
- 239	50	25
- 248	66	25
- 272	90	50
- 2100	125	50
- 2200	250	50
- 2300	375	50
- 2400	500	50
- 2500	625	50
- 2600	750	50
- 2700	900	50
- 2800	1000	50
- 21000	1250	50
- 21200	1500	50
- 21500	1800	50

Inquire regarding other available voltage ratings.



LIGHTNING PROTECTION CORPORATION

Mailing Address : P.O. Box 6086
Santa Barbara, CA 93160

Telephone : (805) 967 4577
(800) 317 4043

Plant Address : 5750 Thornwood Dr.
Goleta, CA 93117

Fax : (805) 967 4320

Website : lightningprotectioncor.com

Email : info@lightningprotectioncor.com